

MANHATTAN
VILLAGE

CLOSE TO HOME. CLOSE TO PERFECT.



MORE FASHION.



MORE FLAVOR.



MORE FUN.

MANHATTAN VILLAGE ENHANCEMENT

Manhattan Beach City Council
September 3, 2013

Why Change?



- Destination retail shopping is evolving
- Make Manhattan Village more inviting ...
 - A gathering place
- Macy's configuration is inefficient
- Connect Northwest corner to main center
- Disconnected sense of place
- Cost of doing nothing

MANHATTAN
VILLAGE

Existing Site Plan



- LEGEND:**
- Existing Mall
 - Existing Retail
 - Expansion Space (1 Level)
 - Expansion Space (2 Level)
 - Building Heights
 - XXX Parking Count
 - MVSC Property Boundary
 - Component Boundary
 - Indicates Existing Accessible Parking Stalls



**MANHATTAN
VILLAGE**

Early Site Plan

DRAFT



MANHATTAN VILLAGE

Early Site Plan

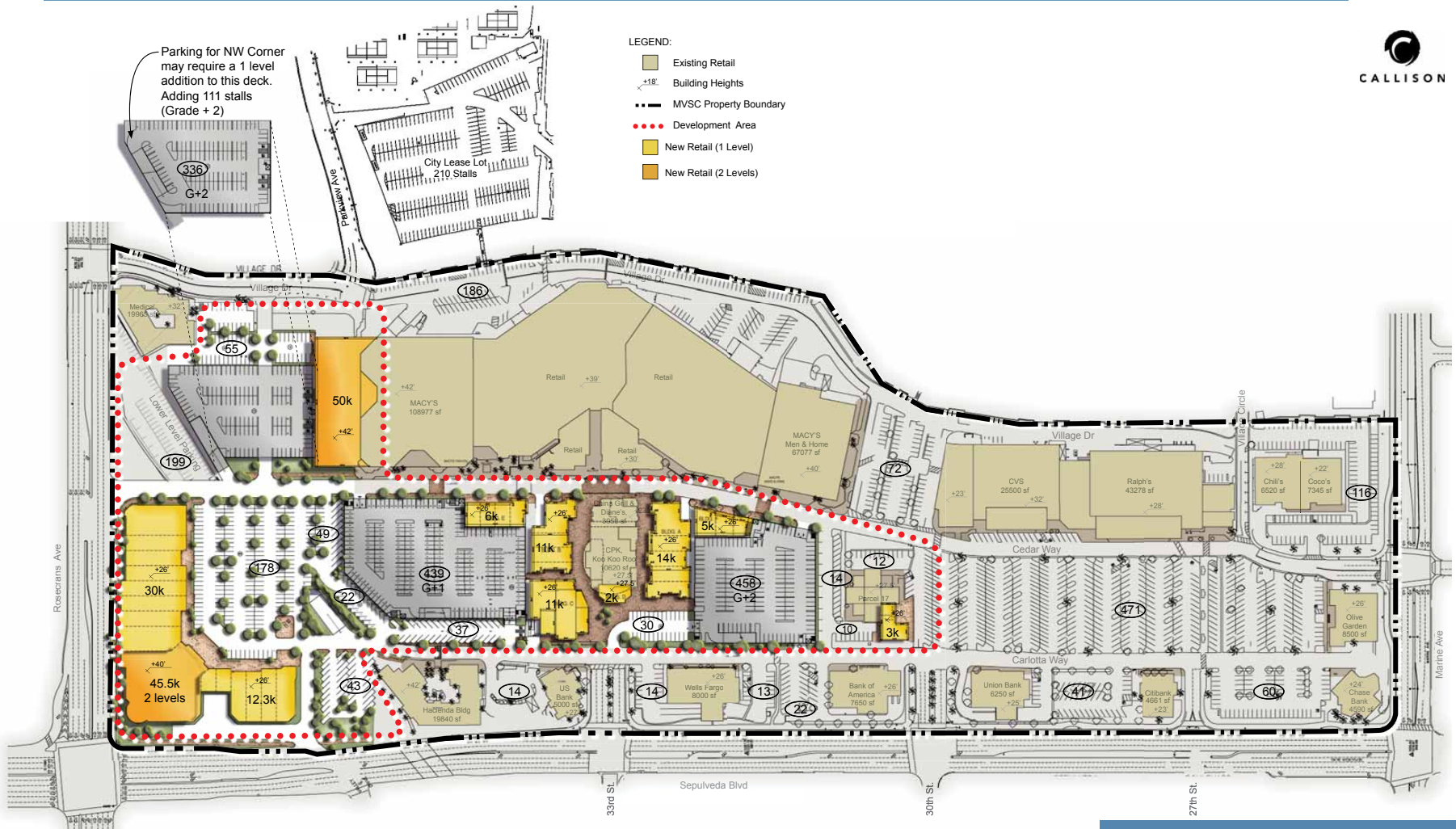

MANHATTAN
VILLAGE

Phase I – Village Shops

Trying to Avoid This Mistake ...



MANHATTAN
VILLAGE

Proposed Project – Completed



MANHATTAN VILLAGE

New Retail Street



Direct Access to Second Level

MANHATTAN
VILLAGE

Proposed Project



- Phase I
 - Reinforce existing mall
 - The Village Shops
- Phase II
 - Macy's consolidation
- Phase III
 - Northwest Corner

MANHATTAN
VILLAGE

Phase I – Village Shops

- Travelway converted to retail street

Phase I – Village Shops

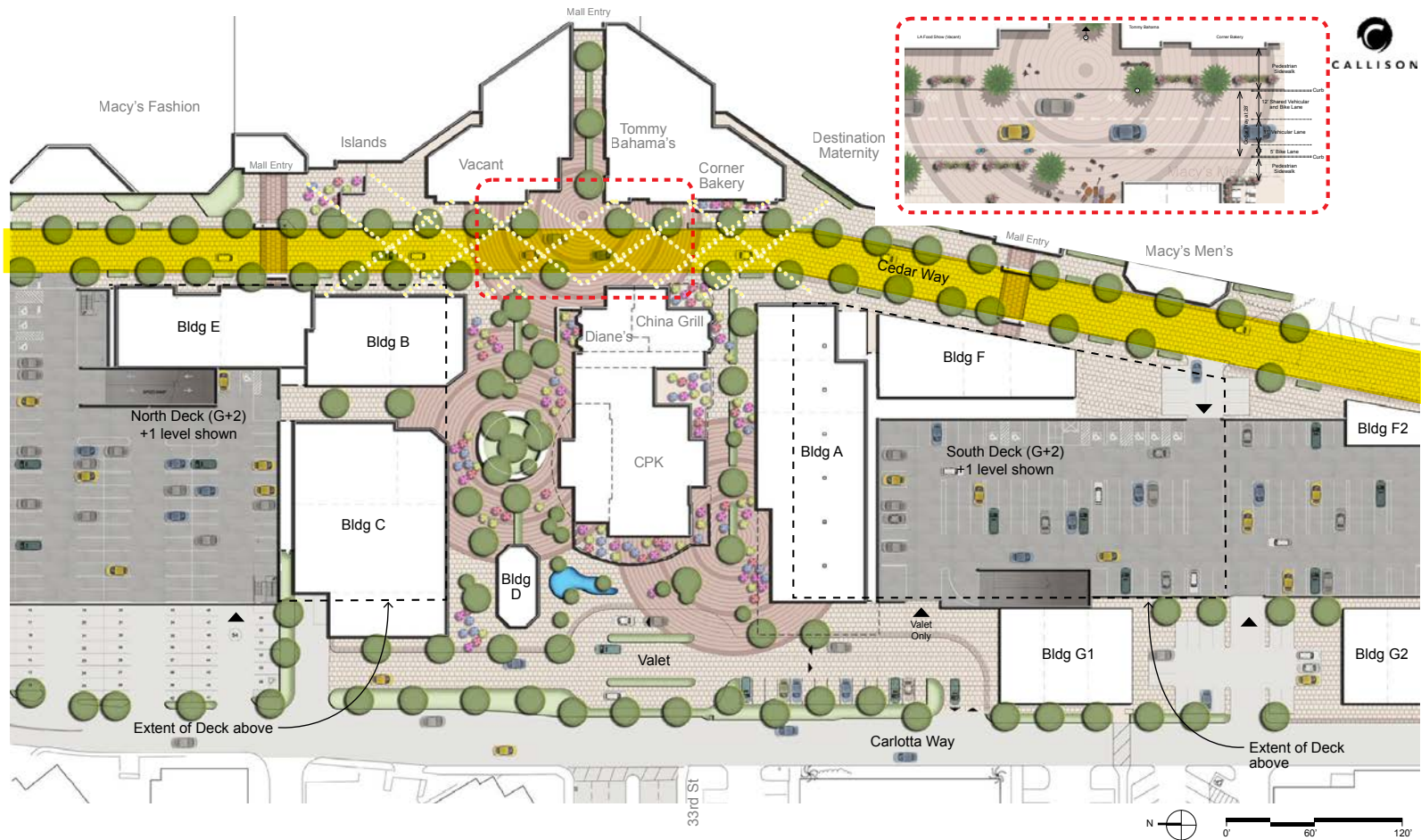

MANHATTAN
VILLAGE

Phase I – Village Shops

Better Place-Making with Village Shops and Cedar Way Main Street



MANHATTAN
VILLAGE

Phase I – Village Shops

- Travelway converted to retail street
- Open-air retail with public space designed for strolling and sitting – not asphalt

Phase I – Village Shops



MANHATTAN
VILLAGE

Phase I – Village Shops

Better Place-Making with Village Shops and Cedar Way Main Street



MANHATTAN
VILLAGE

Phase I – Village Shops

- Travelway converted to retail street
- Open-air retail with public space designed for strolling and sitting – not asphalt
- Connecting new shops to the enclosed mall
 - Multiple clusters of retail synergy

Phase I – Village Shops



MANHATTAN
VILLAGE

Phase I – Interior Improvements



MANHATTAN
VILLAGE

Phase I – Village Shops

- Travelway converted to retail street
- Open-air retail with public space designed for strolling and sitting – not asphalt
- Connecting new shops to the enclosed mall
 - Multiple clusters of retail synergy
- Parking destinations close to retail doors and property entrances

Phase I – Village Shops

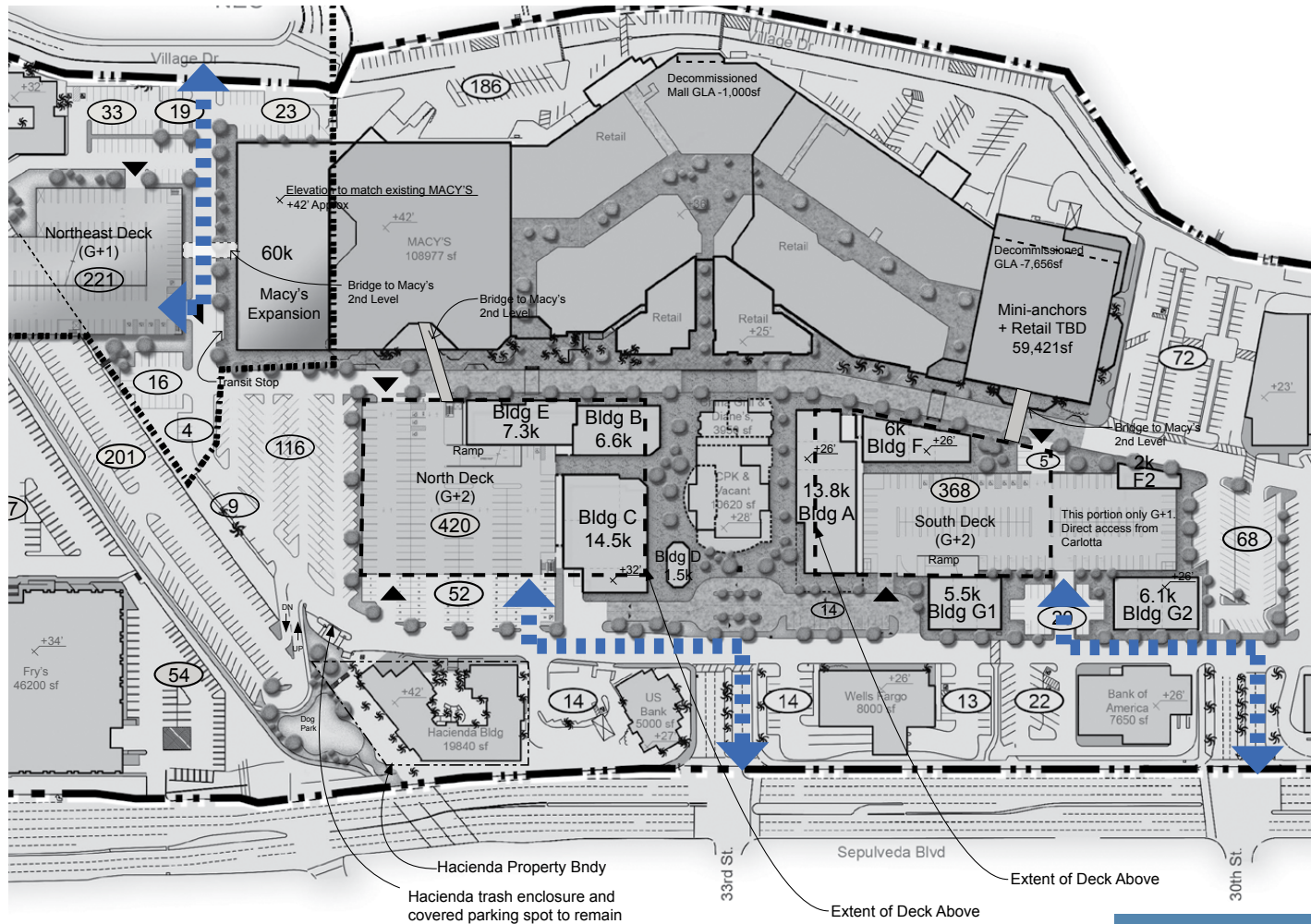

MANHATTAN
VILLAGE

Phase I – Village Shops



MANHATTAN
VILLAGE

Phase I – Village Shops

2013 Plan



Carlotta Way

MANHATTAN
VILLAGE

Phase I – Village Shops



Deck Components



MANHATTAN
VILLAGE

Phase I – Village Shops



North Deck: North Facade

MANHATTAN
VILLAGE

Phase I – Village Shops



MANHATTAN
VILLAGE

Phase I – Village Shops

Trying to Avoid This Mistake ...



MANHATTAN
VILLAGE

Phase I – Village Shops

Current 2013 Plan



MANHATTAN
VILLAGE

Phase I – Village Shops

Better Urban Planning



Multi-use Path Example

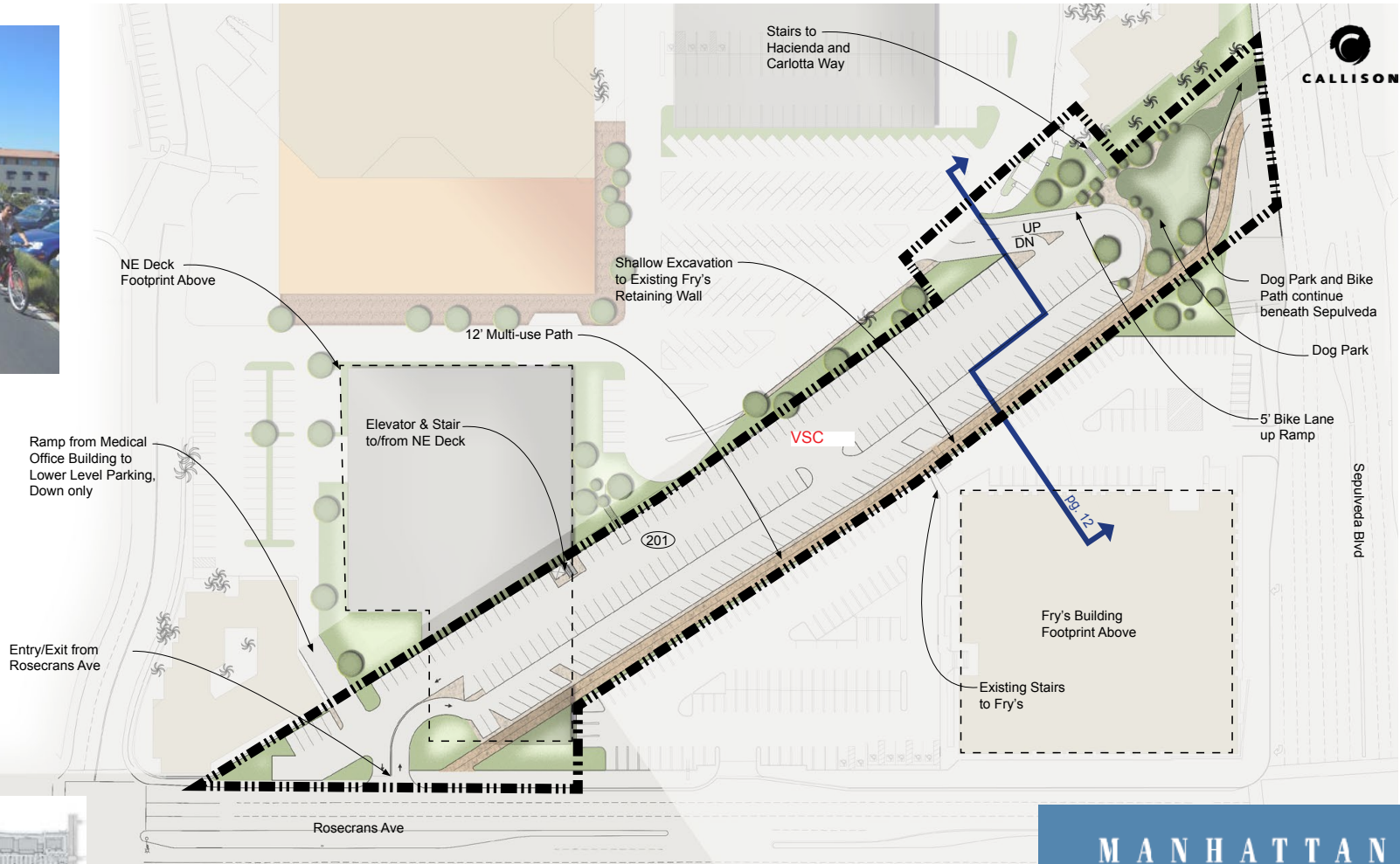

MANHATTAN
VILLAGE

Phase II – Macy's Consolidation

- More-Efficient Macy's Under One Roof
- Convert Men's Store to Mini-Anchors and Shops
- South Deck Upper Level Feeds Mini-Anchor

Phase II – Macy's Consolidation

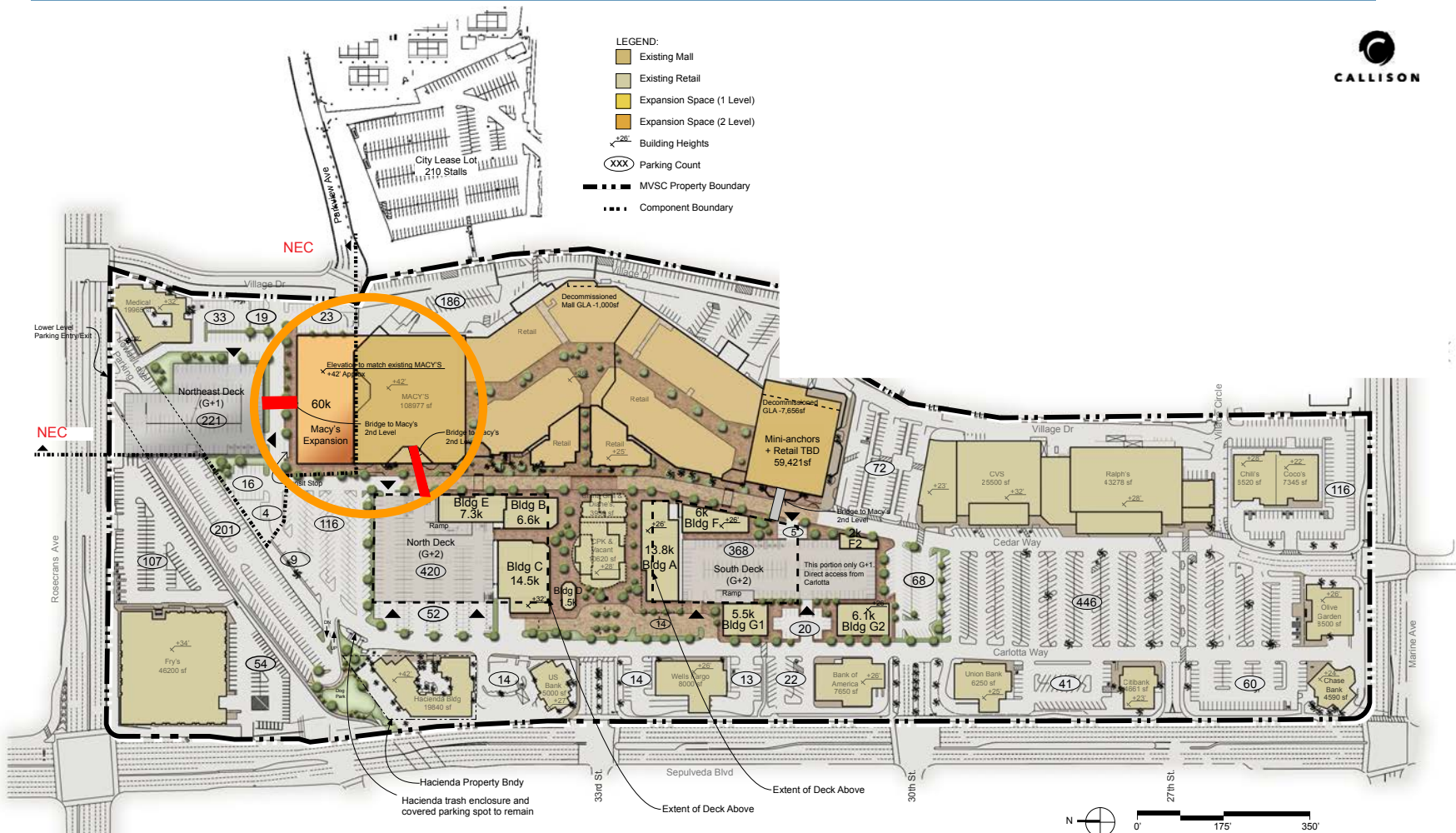

MANHATTAN
VILLAGE

Phase II – Macy's Consolidation

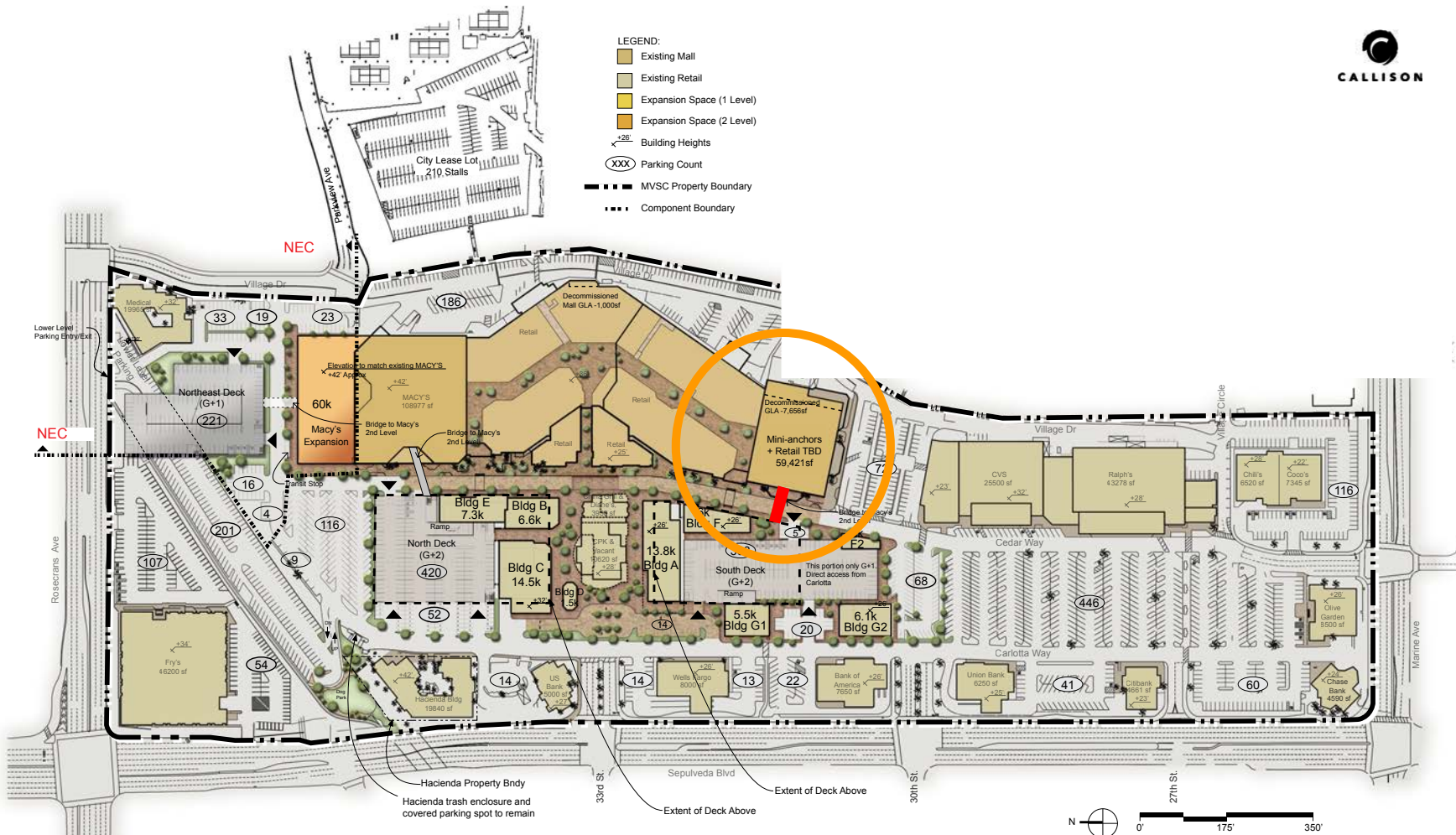

MANHATTAN
VILLAGE

Phase III – Northwest Corner

- Northwest Corner Opportunities
 - Replace Fry's with Mini-Anchor and Shops
- Tie Corner into Main Center
- Add New Main Entrance at Rosecrans, serving entire center
 - Relieves overworked Village and Rosecrans intersection

Phase III – Northwest Corner



MANHATTAN
VILLAGE

Phase III – Northwest Corner



MANHATTAN
VILLAGE



Project Features



MANHATTAN
VILLAGE

Project Benefits to Manhattan Beach

Keep Manhattan Beach Dollars in Manhattan Beach



Retail MarketPlace Profile

90266 (Manhattan Beach)
 90266 (Manhattan Beach, CA)
 Geography: ZIP Code

Prepared by NAI Capital

Summary Demographics

2010 Population	35,338
2010 Households	14,812
2010 Median Disposable Income	\$93,461
2010 Per Capita Income	\$69,135

Industry Summary	NAICS	Demand (Retail Potential)	Supply (Retail Sales)	Retail Gap	Leakage/Surplus Factor	Number of Businesses
Total Retail Trade and Food & Drink	44-45,722	\$869,472,085	\$522,285,186	\$347,186,899	24.9	390
Total Retail Trade	44-45	\$738,977,189	\$387,403,657	\$351,573,532	31.2	253
Total Food & Drink	722	\$130,494,896	\$134,881,529	-\$4,386,633	-1.7	137

MANHATTAN
VILLAGE

Project Benefits to Manhattan Beach

Protect Manhattan Beach Tax Dollars

Total Annual Sales by MVSC Retailers

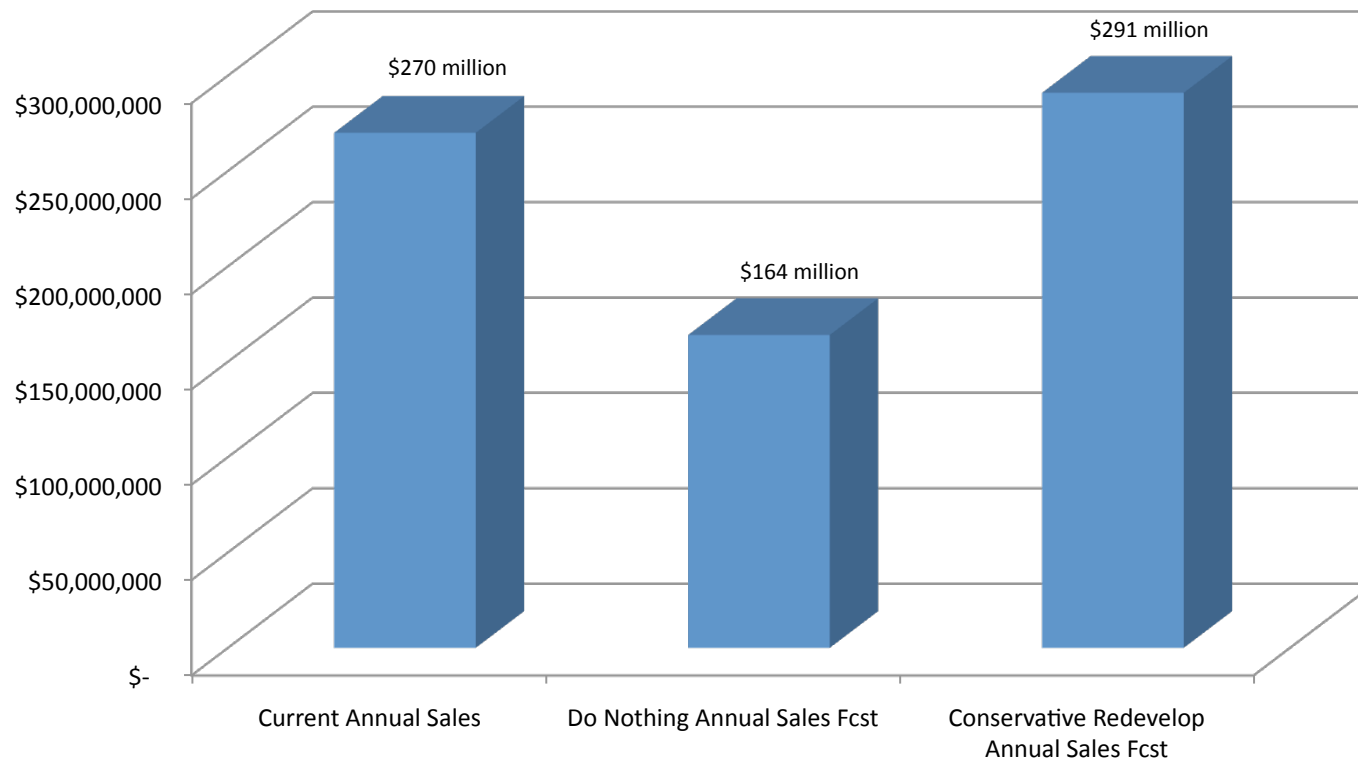

Source: 2012 Allan D. Kotin & Associates Analysis

MANHATTAN
VILLAGE

Project Benefits to Manhattan Beach



*Adjacent Roadway Improvements
& Land Dedication*

MANHATTAN
VILLAGE

Bike Circulation

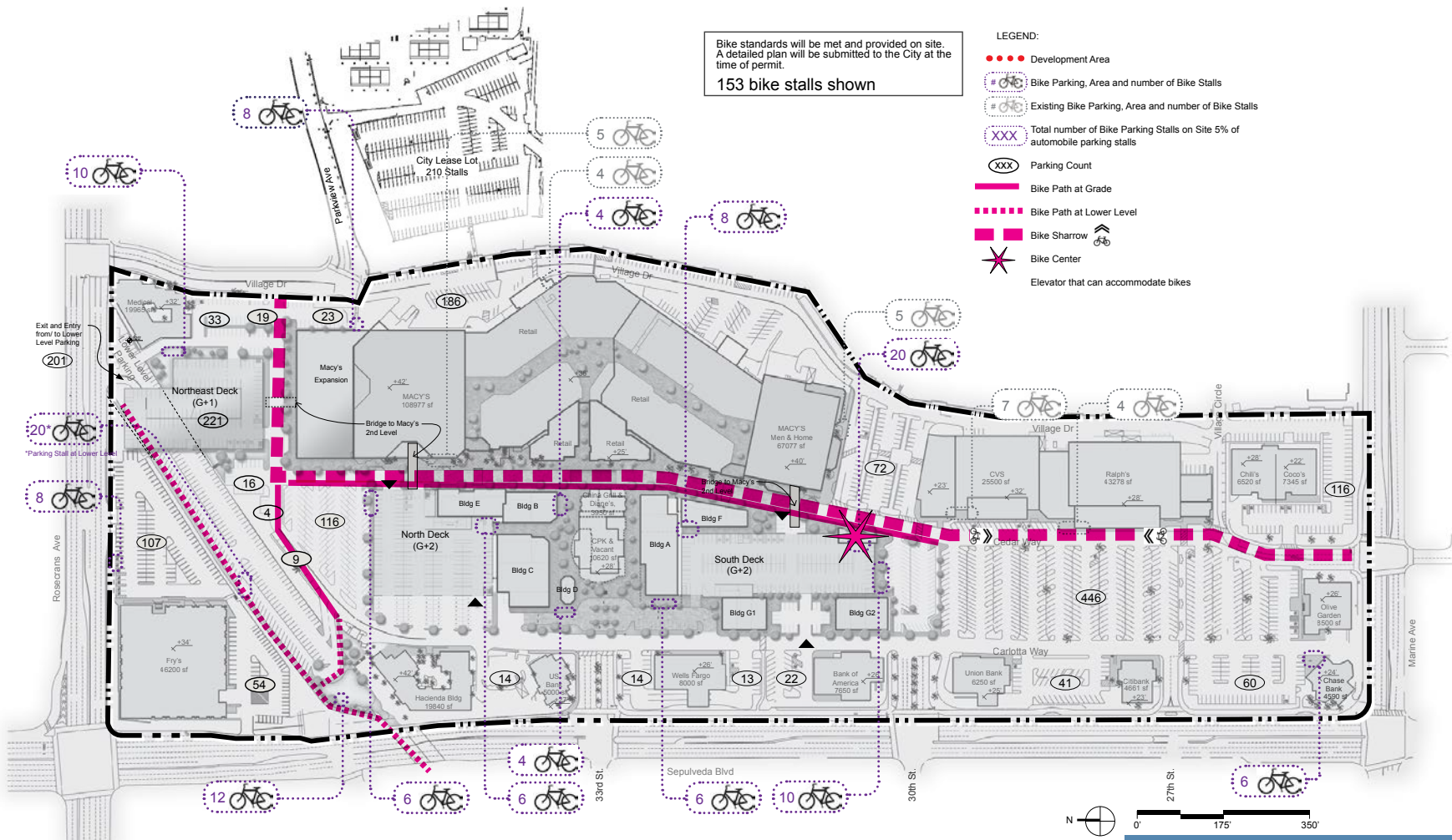

MANHATTAN
VILLAGE

Bike Connectivity



“... It will certainly help stores and restaurants to have a safe path to the shopping center for families ...”

MANHATTAN
VILLAGE

Pedestrian Circulation

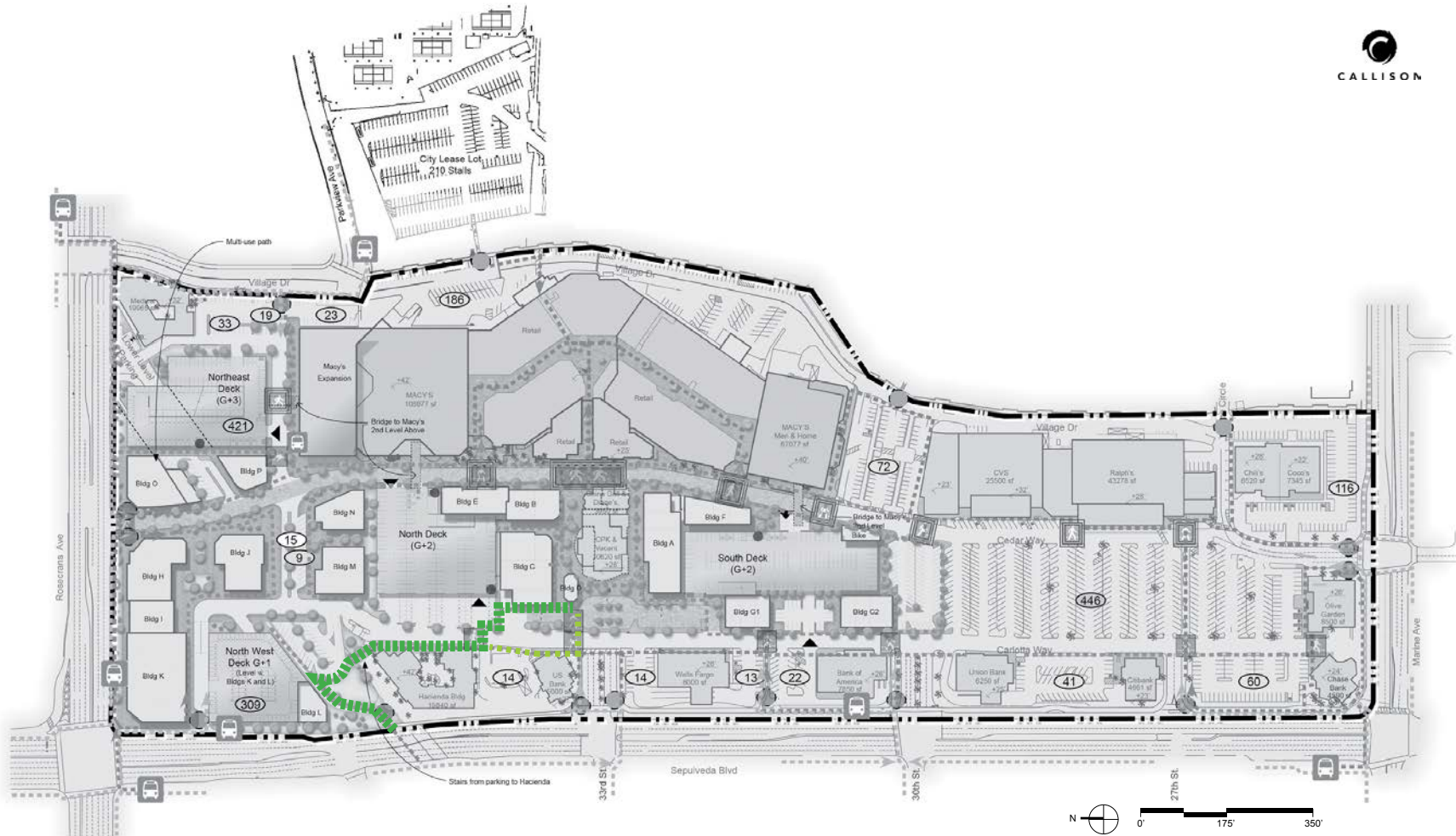

MANHATTAN
VILLAGE

Pedestrian Circulation

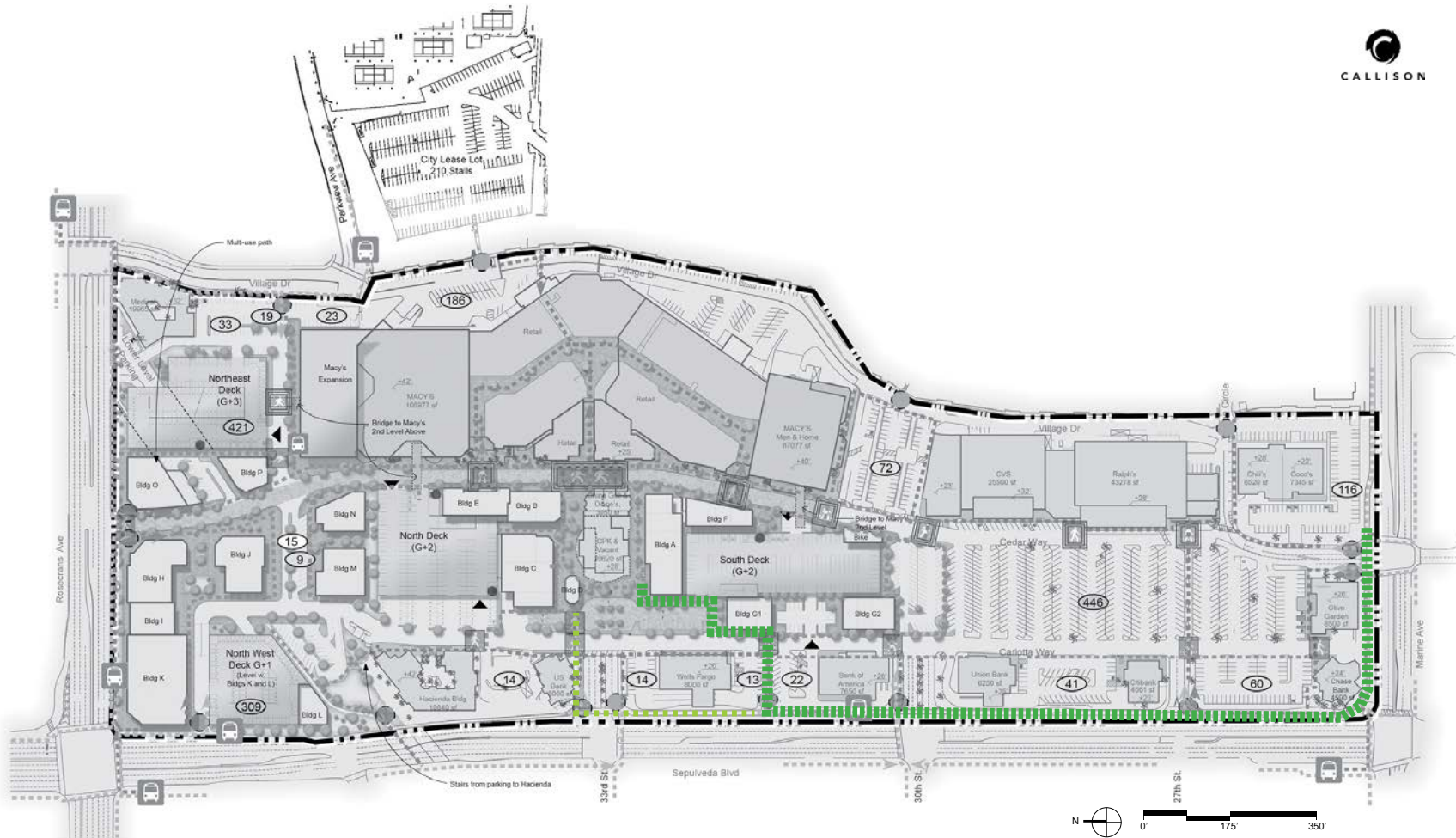

MANHATTAN
VILLAGE

Upgraded Atmosphere



MANHATTAN
VILLAGE

Improved Experience for Visitors

Re-Energize Interior Mall by Combining Macy's / Re-Tenancing Existing Macy's Men's Store



MANHATTAN
VILLAGE

Improved Experience for Visitors



- Better retail mix encourages people to visit, shop, eat and stay

Improved Experience for Visitors

Better Circulation and Parking



MANHATTAN
VILLAGE

Improved Experience for Visitors

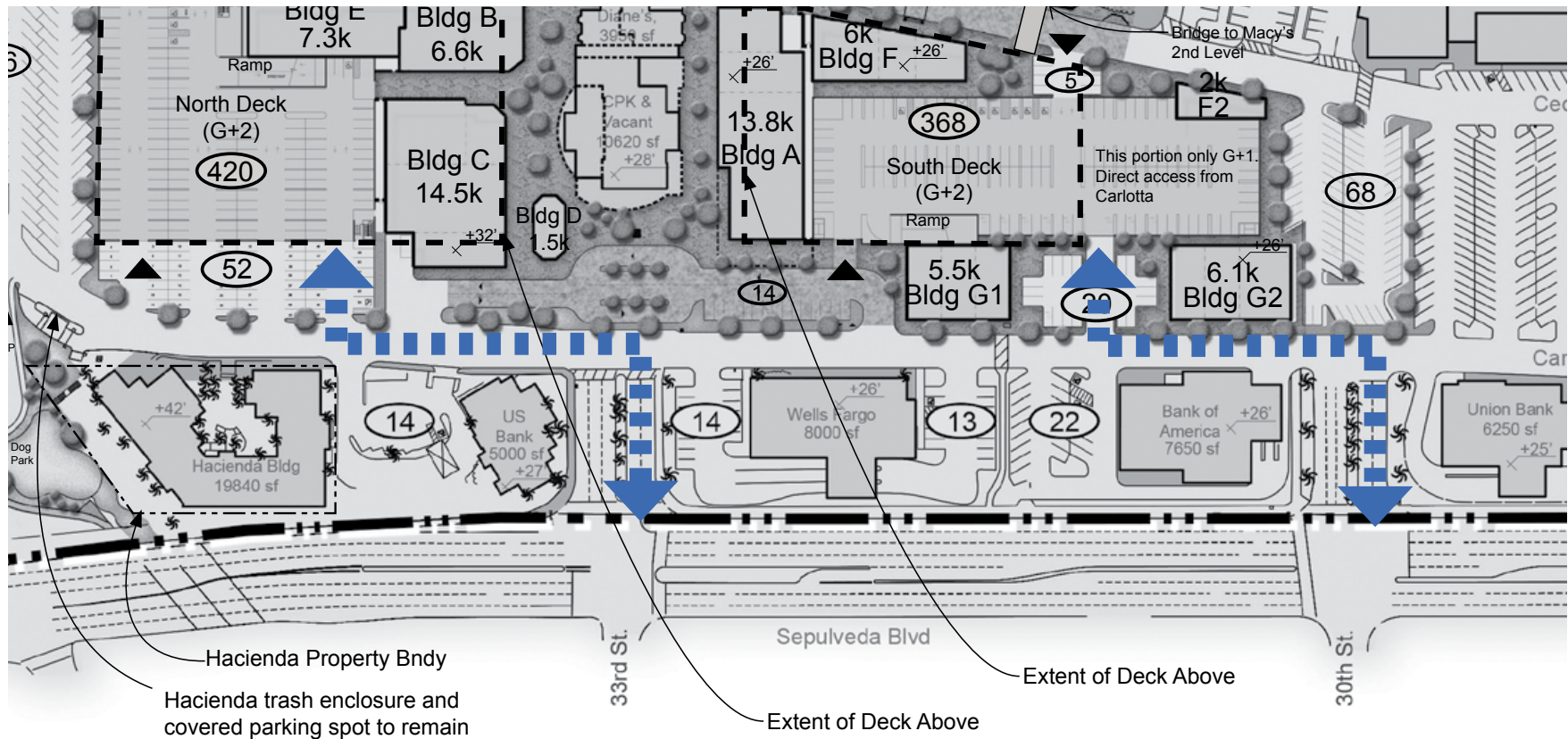

Easy In and Out Parking

MANHATTAN
VILLAGE

Improved Experience for Visitors



MANHATTAN
VILLAGE

Improved Experience for Visitors



Valet parking

MANHATTAN
VILLAGE

New Gateway



MANHATTAN
VILLAGE

EIR Analysis



- City's Analysis is Thorough
- Vetted by Planning Commission and Community
- No Adverse Impacts
- Our Project is Consistent with Analysis

MANHATTAN
VILLAGE

Appeal



- Signage – Adopt the Master Sign Program as Part of Condition 11
- Amend Condition 18 Regarding Square Footage Caps

MANHATTAN
VILLAGE

Thank You



For more information, please visit www.shopmanhattanvillage.com

MANHATTAN
VILLAGE