

# Manhattan Grand Prix

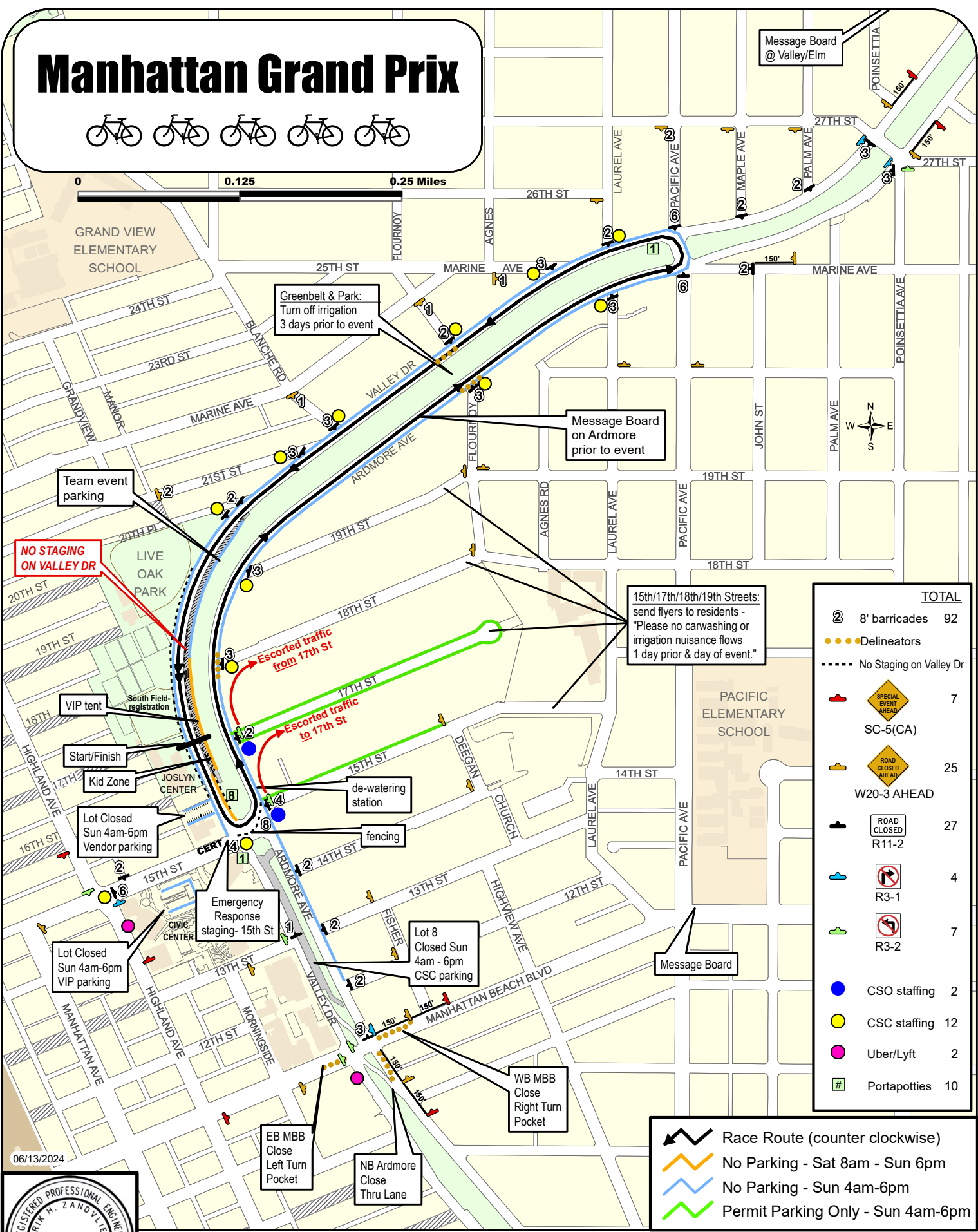

0 0.125 0.25 Miles



TOTAL	
②	8' barricades 92
●●●	Delineators
-----	No Staging on Valley Dr
	SPECIAL EVENT AHEAD 7
	SC-5(CA) 25
	ROAD CLOSED AHEAD
	W20-3 AHEAD 27
	ROAD CLOSED R11-2 4
	R3-1 7
	R3-2 2
	CSO staffing 12
	CSC staffing 2
	Uber/Lyft 10
	Portapotties 2

- Race Route (counter clockwise)
- No Parking - Sat 8am - Sun 6pm
- No Parking - Sun 4am-6pm
- Permit Parking Only - Sun 4am-6pm



Reviewed and Approved: *Erik H. Zandvliet* Date: 06/13/2024

