



# Project Proposal

Prepared for: Bruce Beach

Prepared by: Innovative Sculpture Design LLC, Hunter Brown

June, 6 2023

## Project Details

Title: Harmony

Medium: 316 Stainless Steel

Finish: Automotive finished stainless-steel (color white) paired with a polished accent panel and mirror polished sphere.

Scale: 26'H x 15'6"W x 15'D

Weight: Approx 10,000lbs

Base: 30"h concrete retaining wall with stain sealer

- structural specs for base / foot to be determined by structural engineer
- artwork is welded to a 8'D 1' steel plate with anchor holes
- plate is attached to concrete pad/footing 1' below retaining wall height, allowing 1' of landscape material to cover the attachment giving the appearance that the sculpture is growing out of the landscape bed. (mulch or river stone is an option for inside the retaining wall if maintenance/irrigation is a problem)

Location: Bruce Beach. California



# Scale

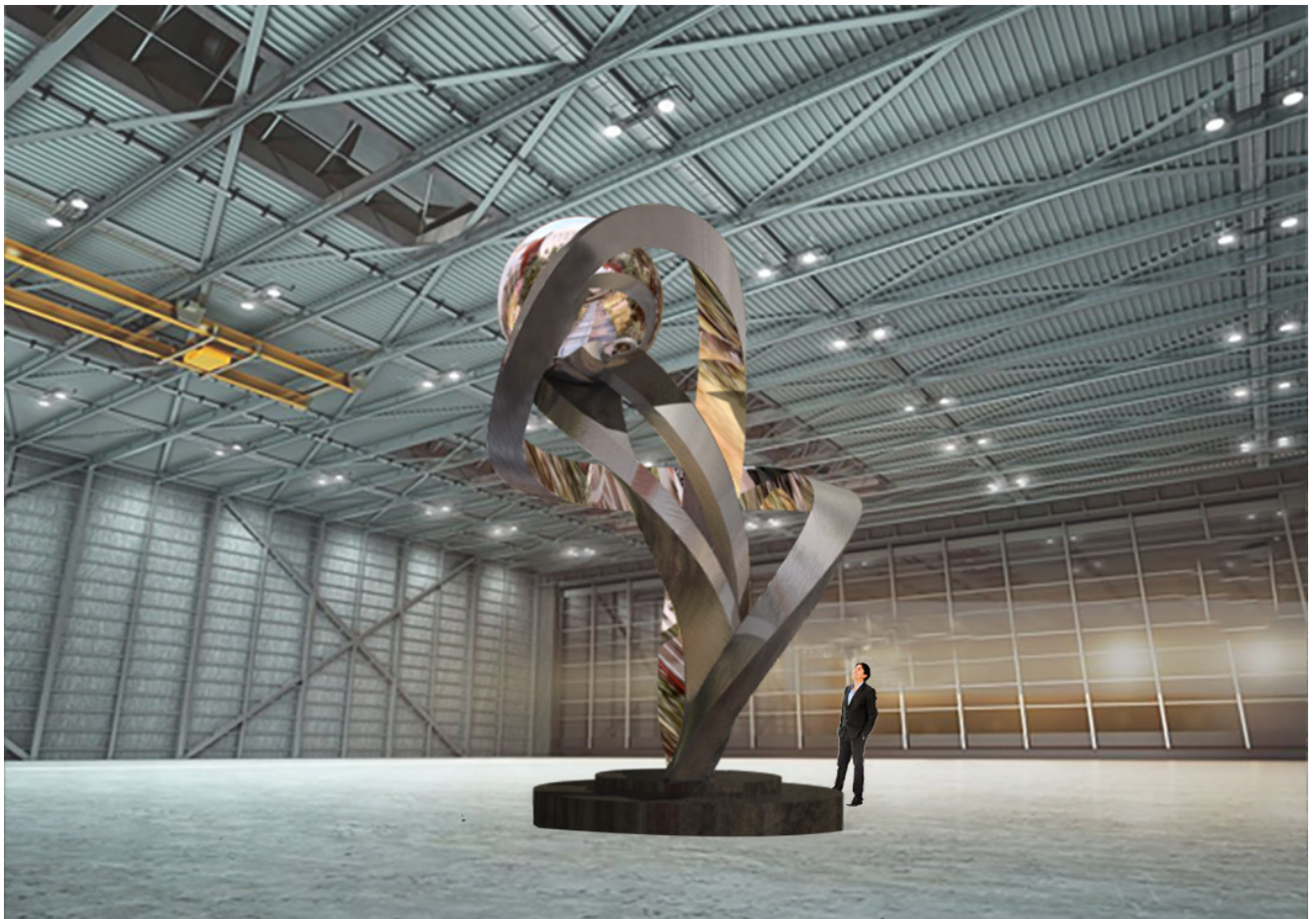
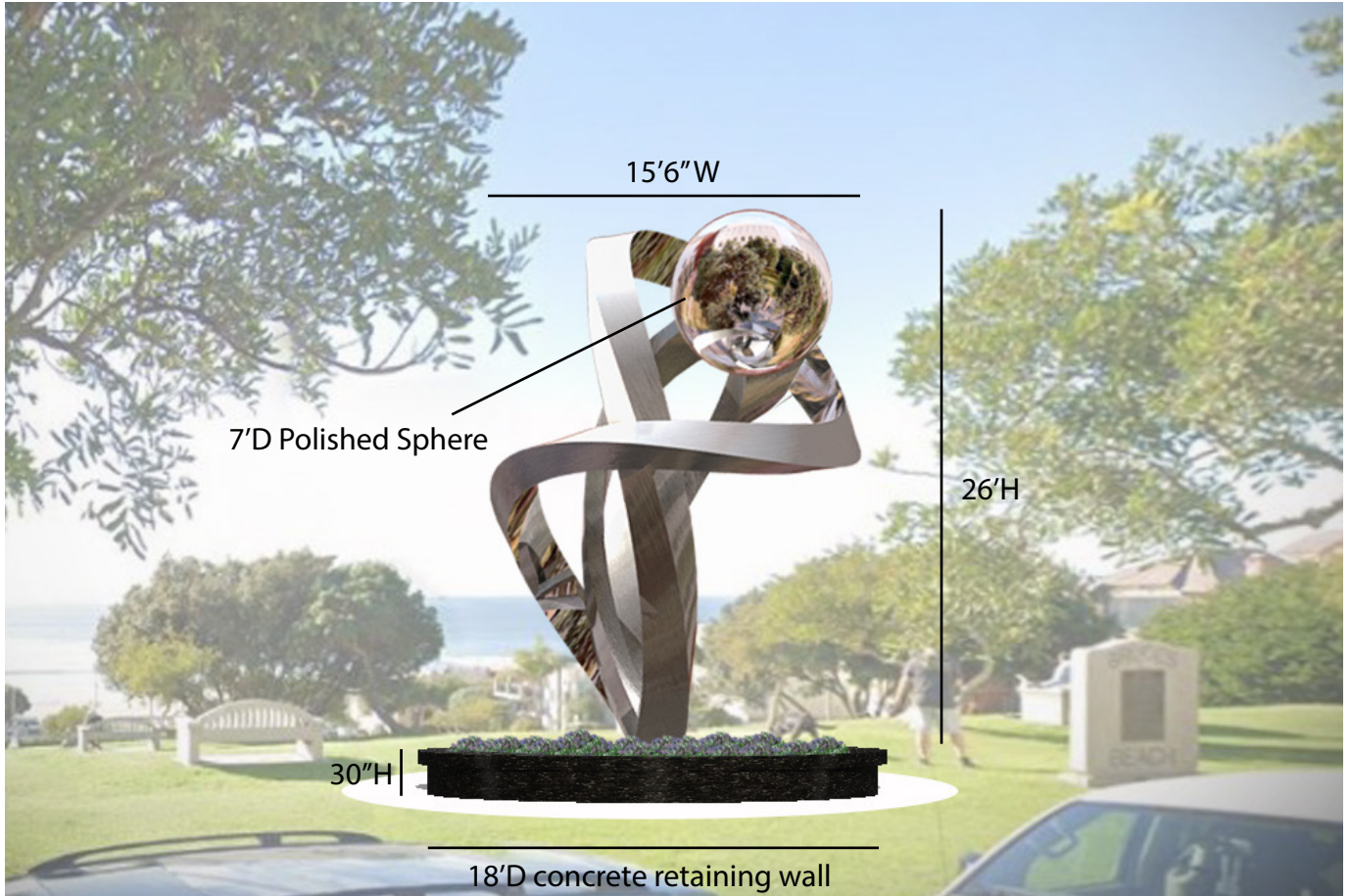



## Similar Finish Samples



## Project Outline

- Proposal submission June 2023
- Artist Selection
- Work with client to complete base, landscape, and hardscape details.
- Contract and Invoice
- Work with engineer on specs for base/footing

---

## Project Plan

We fabricate and complete all stages of the project at Innovative Sculpture Studio in Little Rock, AR. The 8000sq. ft. studio has high structural beams and plenty of space to produce monumental works in house. We have a growing team of assistants trained in all stages of the fabrication and finishing process.

The work is completely assembled before transport, requiring no assembly on site. We transport the artwork using an oversize haul service with escorts. The artwork is set in place on site with a crane and typically the anchors are set in the footing by my team during the installation. The piece is attached to the footing using threaded studs per structural spec. Installation is complete in one day.

This design is my design and will be unique to this location. There will be no duplications or reproductions.

## Maintenance

The piece is constructed in 11 gauge high chromium stainless steel (316 grade) and the sphere is constructed in 3mm thick 316 grade stainless. The material is designed to withstand the elements and the high chromium content protects the piece from oxidation in the harshest environments. The stainless surfaces are coated with transportation grade automotive finish and ceramic coating. The ceramic coating helps to protect the surface from UV and helps to deter water spots. The painted surfaces typically last 10-15 years in harsh elements with proper maintenance.

Maintenance includes washing the piece similar to washing a car. (If pressure washing the psi should be less than 3000psi with a non aggressive tip.) Water and mild soap can be used to wash the sculpture as needed. Applying a new ceramic coating annually helps to prolong the life of the artwork. I would be willing to discuss annual maintenance contracting. This would include washing, light buffing, and the ceramic coating. When the painted surfaces begin to break down artist team can refurbish the artwork on-site upon request.

## Footing

Footing drawings and details will be provided once the base design is confirmed. At that time I will contract a structural engineer to provide spec drawings. The piece will be mounted on a 1" steel plate that will be used to anchor the piece to the concrete footing. We will work with the architect to get bids for the site construction. Lighting does add great presence to the artwork at night. We can help with lighting design if this is of interest.

# Budget

Description	Quantity	Unit Price	Cost
<b>Materials</b>			
4'x10' 11g 316 sheet 2b	26	\$1,250.00	\$ 32,500.00
5'x 10' 11 gauge 316 sheet polished	5	\$3,500.00	\$ 17,500.00
1/2" stainless round	150	\$ 31.20	\$ 4,680.00
2" sch. 10 tube	40	\$ 155.48	\$ 6,219.20
7'D Stainless Steel Sphere			\$30,000.00
3/8" 5'x 10' stainless plate	1		\$ 2,885.00
1" steel plate 8'D cnc milled	1		\$ 4,745.83
8% tax			\$ 5,482.40
Total			\$ 104,012.43
<b>Consumables/Production Cost</b>			
Welding Consumables			\$ 3,000.00
Finish and Abrasives			\$ 5,000.00
Protective film			\$ 500.00
Passivation Wash			\$ 300.00
Scissor Lift Rental			\$ 2,500.00
Telehandler Lift Rental			\$ 2,000.00
Paint Job			\$ 8,000.00
Total:			\$ 21,300.00
<b>Production Labor</b>			
Artist Fee			\$ 30,000.00
Fabrication/Finishing			\$ 140,000.00
<b>Installation</b>			
Transport			\$ 18,000.00
Crane			\$ 1,500.00
Man Lift			\$ 1,000.00
Installation Fee			\$ 2,000.00
Total:			\$ 22,500.00
<b>Site Work/Footing</b>			
Structural Engineer Fee			\$ 3,500.00
Footing Allowance			\$ 25,000.00
Total:			\$ 28,500.00
<b>GrandTotal:</b>			<b>\$ 346,312.43</b>



## Education

2012 Bachelor of Arts, University of Central Arkansas

## Experience

2012-present Professional artist and owner of Innovative Sculpture Studio

## Representation

M2 Gallery - Little Rock, AR

Gallery 221 - Little Rock, AR

## Shows

### 2018

Sculpture at the River Market. Little Rock, AR

Anniversary Show. M2 Gallery. Little Rock, AR

River Arts Fest. Memphis, TN

### 2017

Main Street Fort Worth Arts Festival. Dallas, TX

Sculpture at the River Market. Little Rock, AR

### 2016

Great Gulf Coast Arts Festival. Pensacola, FL

Sculpture at the River Market. Little Rock, AR

River Arts Fest. Memphis, TN

Ann Arbor Summer Art Fair. Ann Arbor, MI

Uptown Artfair. Minneapolis, MN

Boston Mills Artfair. Boston Mills, OH

Three Rivers Artfest. Philadelphia, PA

Oldtown Art Fair. Chicago, IL

Boardwalk Art Show, 61st Annual. Virginia Beach, VA

Woodlands Waterway Arts Festival. Woodlands, TX

Pecan Street Festival. Austin, TX

### 2015

Cherry Arts Festival at Stanley. Denver, CO

Zona Rosa Arts Festival. Kansas City, MO

Great Gulf Coast Arts Festival. Pensacola, FL

Artfest Scottsdale. Scottsdale, AZ

Bayou City Arts Festival. Houston, TX

River Arts Fest. Memphis, TX

Sculpture at the River Market. Little Rock, AR

### 2014

Cottonwood Arts Festival. Richardson, TX

Art at the Domain. Austin, TX

Houston Fine Arts Festival. Houston, TX

San Antonio Fine Arts Festival. San Antonio, TX

Fall Fest Fine Art Show. Boulder, CO

Sculpture at the River Market. Little Rock, AR

Arkansas Sculptors Guild Show and Sale. Little Rock, AR



# Commissions and Installations

## 2022

Aurora Highlands. Multiple pieces \*public art director. Highlands Creek Park, Aurora, CO. (2022-2025)  
Unity 22'H, MLK Park, Conway, AR (Scheduled install Dec, 2023)  
Solidarity 40'H, City of Orlando. (Scheduled install April 2022)  
Surge 10'H, Port St. Lucie, FL. (Scheduled Install May 2022)  
Life Blood 30'H, Aurora Highlands. Aurora, CO. (Scheduled install July 2022)  
St. Margarets Cross 18'H, Little Rock, AR (Scheduled install May 2022)

## 2021

Helios 18', Tech Park, Sculpture at the River Market Award. Little Rock, AR  
Take-Off 15', Park Village Shopping Center. Southlake, TX  
Pioneer 10', Muskogee, MI  
Infatuation 8', Osage Beach, MZ

## 2020

Embrace 25', City of Hamilton Ohio 20th Anniversary Sculpture. Hamilton, OH  
Reciprocity 30', Midtown District/Reno, NV Public Art Award. Reno, NV  
Stellar 25', The Pointe at North Hills. North Little Rock, AR  
Salute 10', The Woodlands Arts District. The Woodlands, TX  
Eclipse 18', Residential commission. Winter Park, FL  
Moon Wave 10', Residential commission. Winter Park, FL  
Eros 8', Paradise Palms and Sculpture Garden. Delray Beach, FL

## 2019

Gravity II 8', corporate commission. Thousand Oaks, CA  
Cascade II 9', Industrial Innovation Group. United Arab Emirates  
Elephant Dreams II 8', Industrial Innovation Group. United Arab Emirates  
Gravity 7', private. Myrtle Beach, SC  
Synergy 20', Lloyd Jones Multi-family investment. Miami, FL  
Setting Sail 12', private commission. Boca Raton, FL

## 2018

Scope, aluminum wall sculpture for Pyramid Penthouse. Little Rock, AR  
Torque, 25' sculpture for Barber Motorsports Park. Birmingham, AL  
The Last Link, 8' sculpture for private residence. Houston, TX  
Bridge of Life, 6' sculpture for private residence. Houston, TX  
Memorial Crosses 15', Sugar Hill Methodist Church. Texarkana, AR  
Eternity 12' sculpture, Paradise Palms and Sculpture Garden. Delray Beach, FL  
Elephant Dreams 8', Paradise Palms and Sculpture Garden. Delray Beach, FL  
Flux IV', Private Commission. Denmark

## 2017

Church at Rock Creek Crosses. Little Rock, AR  
Wings, private memorial commission. Minneapolis, MN  
Ascension, Contemporary sister pieces for West 77 Apartments. Chicago, IL  
Triumph, 25' monumental roundabout installation curated by the City of Bentonville. Bentonville, AR  
Paleo II, private residence. Sea Girt, NJ  
St. Margarets Cross, St. Margarets Episcopal Church. Little Rock, AR  
Flux II, Konstruktorska Business Center. Warsaw, Poland  
Verve IV, The Executive Centre. Taipei, Taiwan  
Legacy 15', Bowman Pointe Luxury Apartments. Little Rock, AR  
Legacy II, Pyramid Building. Little Rock, AR

## 2016

Escape II, private. Austin, TX  
Essence, sister pieces for Col Glenn Nursing and Rehabilitation Center. Little Rock, AR  
Verve III, private. Chicago, IL  
Paleo, Argo Sculpture Park. Athens, GA  
Flux, Argo Sculpture Park. Athens, GA  
Verve II, private. Austin, TX  
Verve I, private. Austin, TX  
Flux II, private. Dallas, TX

## 2015

Mobius, private. Boca Raton, FL  
Escape, private. Little Rock, AR  
Kink, Winn Whitman Architecture. Austin, TX  
Geo Table, private. Little Rock, AR





Title: Solidarity  
Material: Marine-Grade Stainless-Steel  
Scale: 40'Hx 16'W x 17'D  
Location: Orlando, Florida  
Commissioned by: City of Orlando  
Budget: \$400,000.00  
Year: 2022





Title: Life Blood  
Material: Automotive Finished Stainless-Steel  
Scale: 28'H x 16'W x 15'D  
Location: Aurora, Colorado  
Comissioned by: The Aurora Highlands  
Budget: \$300,000.00  
Year: 2022





Title: Unity

Material: Marine-Grade Stainless-Steel

Scale: 22'H x 10'W x 10'D

Location: Little Rock, Arkansas

Commissioned by: City of Conway

Budget: \$130,000.00

Year: 2023





Title: Helios

Material: Marine-Grade Stainless-Steel

Scale: 24'H x 8'W x 8'D

Location: Little Rock, Arkansas

Commissioned by: Sculpture at the River Market

Budget: \$250,000.00

Year: 2021





**Title:** Embrace  
**Material:** Marine-Grade Stainless-Steel  
**Scale:** 25'H x 16'W x 16'D  
**Location:** Hamilton, Ohio  
**Commissioned by:** City of Sculpture  
**Budget:** \$250,000.00  
**Year:** 2020





Title: Reciprocity  
Medium: Marine-Grade Stainless-Steel  
Scale 30'H x 16'W x 12'D  
Location: Reno, Nevada  
Commissioned by: City of Reno  
Budget: \$200,000.00  
Year: 2020





Title: Stellar  
Material: Marine-Grade Stainless-Steel  
Scale: 25'H x 15'W x 13'D  
Location: Little Rock, Arkansas  
Commissioned by: RichSmith Developers  
Budget: \$150,000.00  
Year: 2020





Title: Triumph

Material: Marine-Grade Stainless-Steel

Scale: 25'H x 14'W x 14'D

Location: Bentonville, Arkansas

Commissioned by: RichSmith Developers

Budget: \$80,000.00

Year: 2017



Keith Richardson  
Owner of RichSmith Development and Richardson Properties  
keith@richsmithdev.com  
501.350.9865

Dr. Dean Kumpuris  
Dkumpuris@littlerock.gov  
501.607.2253

Mary-Stewart Droedge  
City of Orlando  
Mary-Stewart.Droege@cityoforlando.net  
407.246.3276

Tamara McMillan  
Southlake Arts Council  
tamaramcmillan@yahoo.co



Dear members of the selection committee,

It is with great interest that I have learned of the public art opportunity for Bruce Beach. I am the proud owner of Innovative Sculpture Design LLC, a design and fabrication studio specializing in site-specific sculpture works in a variety of formats ranging from smaller residential installations to monumental public art and commercial art installations. After graduating from UCA I opened Innovative Sculpture Studio in Little Rock, AR, where I have now been creating sculpture for almost 10 years. The studio is 8000sq ft and is set up for simultaneous production of monumental works. I currently have a team of full-time assistants that are trained in all stages of fabrication and finishing.

My work can be found in permanent collections in over 25 states and 3 countries. My ability to work with curators, designers, and clients to produce world-class artwork that is both dynamic and place making can be seen in my body of work. Most of my projects are one of a kind, site-specific works designed with the intent to beautify the space they live in.

While my works are modern semi-abstract by design they typically are uplifting and represent a message of Unity and Strength. My proposed design is composed of twisting forms spiraling upward, where they converge around a polished sphere. I used the sphere in many of my works as a focal point but also to represent the world or the communities we live in. The twisting forms in the work represent the individuals in the community working together to embrace the sphere which represents the embodiment of the community. The sculpture itself appears to grow out of the ground in which it is routed which I think really ties it to the legacy of Will and Charles Bruce. The design has great movement and is dynamic by design. The movement creates interesting views from all angles and perspectives.

I would be honored to have the opportunity too create an iconic work that would honor the legacy of Will and Charles.

Thank you,

Hunter



## Education

2012 Bachelor of Arts, University of Central Arkansas

## Experience

2012-present Professional artist and owner of Innovative Sculpture Studio

## Representation

M2 Gallery - Little Rock, AR

Gallery 221 - Little Rock, AR

## Shows

### 2018

Sculpture at the River Market. Little Rock, AR  
Anniversary Show. M2 Gallery. Little Rock, AR  
River Arts Fest. Memphis, TN

### 2017

Main Street Fort Worth Arts Festival. Dallas, TX  
Sculpture at the River Market. Little Rock, AR

### 2016

Great Gulf Coast Arts Festival. Pensacola, FL  
Sculpture at the River Market. Little Rock, AR  
River Arts Fest. Memphis, TN  
Ann Arbor Summer Art Fair. Ann Arbor, MI  
Uptown Artfair. Minneapolis, MN  
Boston Mills Artfair. Boston Mills, OH  
Three Rivers Artfest. Philadelphia, PA  
Oldtown Art Fair. Chicago, IL  
Boardwalk Art Show, 61st Annual. Virginia Beach, VA  
Woodlands Waterway Arts Festival. Woodlands, TX  
Pecan Street Festival. Austin, TX

### 2015

Cherry Arts Festival at Stanley. Denver, CO  
Zona Rosa Arts Festival. Kansas City, MO  
Great Gulf Coast Arts Festival. Pensacola, FL  
Artfest Scottsdale. Scottsdale, AZ  
Bayou City Arts Festival. Houston, TX  
River Arts Fest. Memphis, TX  
Sculpture at the River Market. Little Rock, AR

### 2014

Cottonwood Arts Festival. Richardson, TX  
Art at the Domain. Austin, TX  
Houston Fine Arts Festival. Houston, TX  
San Antonio Fine Arts Festival. San Antonio, TX  
Fall Fest Fine Art Show. Boulder, CO  
Sculpture at the River Market. Little Rock, AR  
Arkansas Sculptors Guild Show and Sale. Little Rock, AR



# Commissions and Installations

## 2023

Unity 24', MLK Square. Conway, AR  
Surge 10', Aqua Dimensions Percent for Art. Port St. Lucie, FL  
Symphony 16', Innovation Tower. Orlando, FL  
Swoop 18', Modern Storage, Springdale, AR (install scheduled for May)  
Asclepius 32', Aurora Highlands, Aurora, CO (Install scheduled for June)  
Vitality 30', UAMS TOSH, Little Rock, AR (Install scheduled for August)

## 2022

Solidarity 40', I4 Public Art Award. Orlando, FL  
Life Blood 30', Aurora Highlands. Aurora, CO  
St. Margaret's Cross 20', St. Margarets Episcopal. Little Rock, AR

## 2021

Helios 18', Tech Park, Sculpture at the River Market Award. Little Rock, AR  
Take-Off 15', Park Village Shopping Center. Southlake, TX

## 2020

Embrace 25', City of Hamilton Ohio 20th Anniversary Sculpture. Hamilton, OH  
Reciprocity 30', Midtown District/Reno, NV Public Art Award. Reno, NV  
Stellar 25', The Pointe at North Hills. North Little Rock, AR  
Salute 10', The Woodlands Arts District. The Woodlands, TX  
Eclipse 18', Residential commission. Winter Park, FL  
Moon Wave 10', Residential commission. Winter Park, FL  
Eros 8', Paradise Palms and Sculpture Garden. Delray Beach, FL

## 2019

Gravity II 8', corporate commission. Thousand Oaks, CA  
Cascade II 9', Industrial Innovation Group. United Arab Emirates  
Elephant Dreams II 8', Industrial Innovation Group. United Arab Emirates  
Gravity 7', private. Myrtle Beach, SC  
Synergy 20', Lloyd Jones Multi-family investment. Miami, FL  
Setting Sail 12', private commission. Boca Raton, FL  
Ascend 20', The Pointe at North Little Rock Luxury Apartments. North Little Rock, AR

## 2018

Scope, aluminum wall sculpture for Pyramid Penthouse. Little Rock, AR  
Torque, 25' sculpture for Barber Motorsports Park. Birmingham, AL  
The Last Link, 8' sculpture for private residence. Houston, TX  
Bridge of Life, 6' sculpture for private residence. Houston, TX  
Memorial Crosses 15', Sugar Hill Methodist Church. Texarkana, AR  
Eternity 12' sculpture, Paradise Palms and Sculpture Garden. Delray Beach, FL  
Elephant Dreams 8', Paradise Palms and Sculpture Garden. Delray Beach, FL  
Flux IV', Private Commission. Denmark

## 2017

Church at Rock Creek Crosses. Little Rock, AR  
Wings, private memorial commission. Minneapolis, MN  
Ascension, Contemporary sister pieces for West 77 Apartments. Chicago, IL  
Triumph, 25' monumental roundabout installation curated by the City of Bentonville. Bentonville, AR  
Paleo II, private residence. Sea Girt, NJ  
St. Margarets Cross, St. Margarets Episcopal Church. Little Rock, AR  
Flux II, Konstruktorska Business Center. Warsaw, Poland  
Verve IV, The Executive Centre. Taipei, Taiwan  
Legacy 15', Bowman Pointe Luxury Apartments. Little Rock, AR  
Legacy II, Pyramid Building. Little Rock, AR

## 2016

Escape II, private. Austin, TX  
Essence, sister pieces for Col Glenn Nursing and Rehabilitation Center. Little Rock, AR  
Verve III, private. Chicago, IL  
Paleo, Argo Sculpture Park. Athens, GA  
Flux, Argo Sculpture Park. Athens, GA  
Verve II, private. Austin, TX  
Verve I, private. Austin, TX  
Flux II, private. Dallas, TX