

Begg Pool Modernization Study Findings and Conceptual Designs Parks and Recreation Commission

March 25, 2024



Note: This PowerPoint presentation is intended solely as a visual aid to an oral staff presentation of an agenda report topic. In the event of any differences between the presentation and the agenda report, the information in the agenda report prevails.

Study Summary

- Study
 - Started August 2023
 - Concludes April 2024
- Survey
 - October 2023 – January 2024
 - 1400+ Respondents
- Community Engagement #1
 - November 13, 2023
 - Approx. 80 people attended
- Community Engagement #2
 - February 27, 2024
 - Approx. 50 in-person/50 on Zoom



Community Engagement



Community Survey & First Meeting

Musts:

- More Water - Larger Pool/Pools
- Upgraded Bathrooms & Locker Rooms

Desires:

- Increased Pool Availability
- Increased Recreation
- Outdoor Showers & Other Deck Improvements
- More Seating & Shade
- Water Safety Training

Concerns:

- Pool Access During Construction
- Parking
- Neighborhood Impacts
- Funding

More Information on Survey and Community Engagement Findings can be found here: www.manhattanbeach.gov/BeggPoolProject



Needs Assessment

March 25, 2024



Note: This PowerPoint presentation is intended solely as a visual aid to an oral staff presentation of an agenda report topic. In the event of any differences between the presentation and the agenda report, the information in the agenda report prevails.

Existing Conditions



Option 1:

- Modernize Existing Pool Building and Pool

Option 2:

- New Construction of Pool Building and Pool/Pools



Project Program Highlights

Site Program

Increased Pool Area
(Opt 2)

Flexible Deck Space

Bleacher & Terraced Seating

Lawn Area

Parking & Drop-Off Improvements

Comprehensive Site Upgrades

Building Program

Community Locker Rooms

Lifeguard & MBUSD Office Space

Flexible Training Space

Lobby & Check-In

Pool Support Space

Comprehensive Building Upgrades
(Opt 1)



Conceptual Designs

March 25, 2024



Concept Inspiration



SWIMMING



WAVES



WATER



DUNES



**REFLECTION OF
MANHATTAN
BEACH**



Site Design Vision



**BUILT ON
THE DUNES**



Site Design Landscape Approach



Coastal



native - climate adaptive - low maintenance - seasonal



OPTION 1

Renovation of Existing Pool & Building

March 25, 2024



Site Plan Option 1

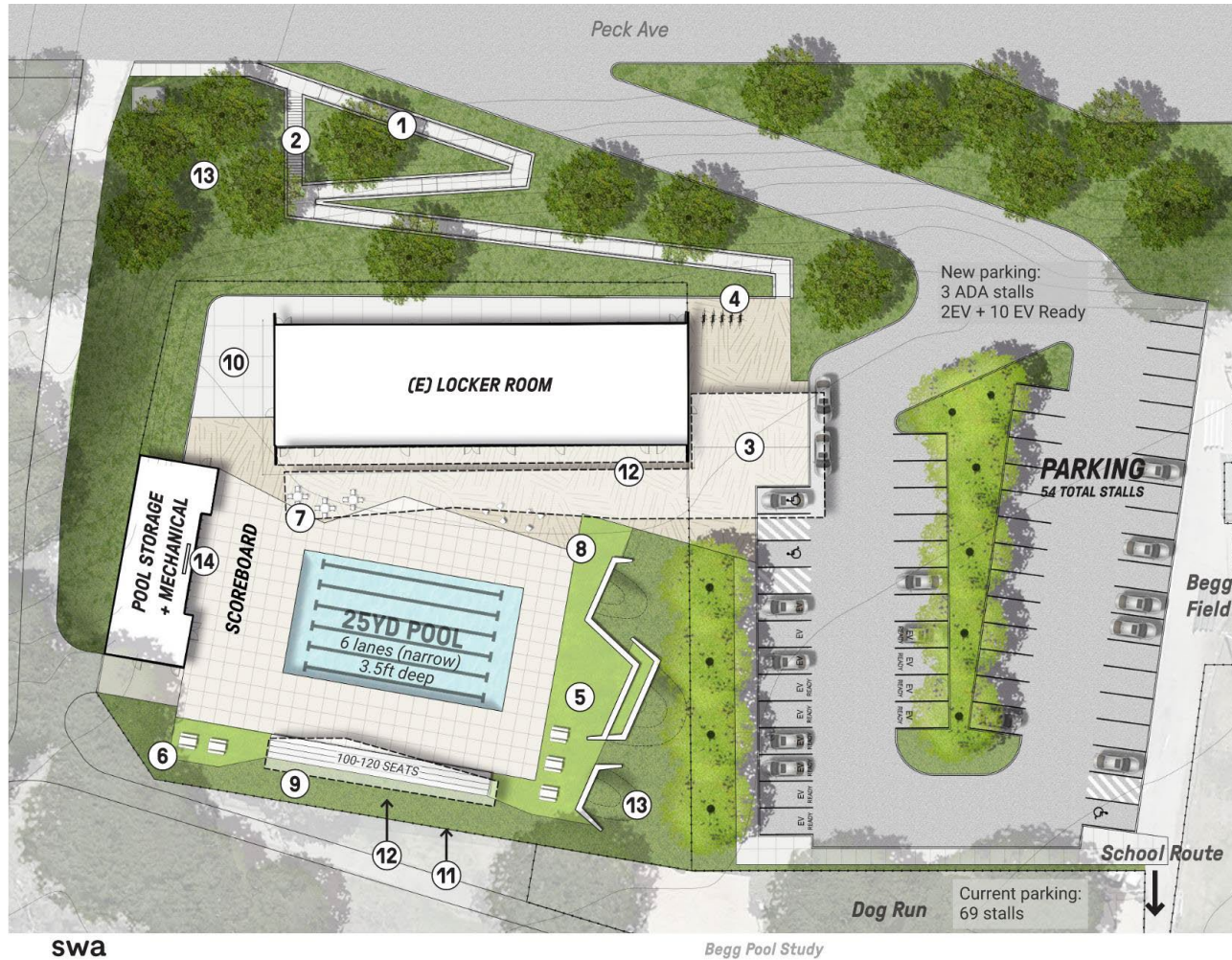

SITE PROGRAM OPTION 1

LEGEND

- ① Accessible Ramp
- ② Entry Stairs
- ③ Entry Plaza
- ④ Bike Parking
- ⑤ Huddle
Flexible Lawn + Seating
- ⑥ Picnic Area
- ⑦ Pool Deck Seating
- ⑧ Artificial Turf
- ⑨ Bleachers
- ⑩ Outdoor Storage
- ⑪ Perimeter Fence
- ⑫ Shade Canopy
- ⑬ Planting Area
- ⑭ Outdoor Showers (11)

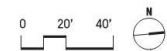

Floor Plan – Option 1

OPTION 1

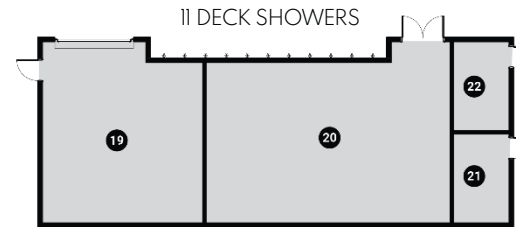
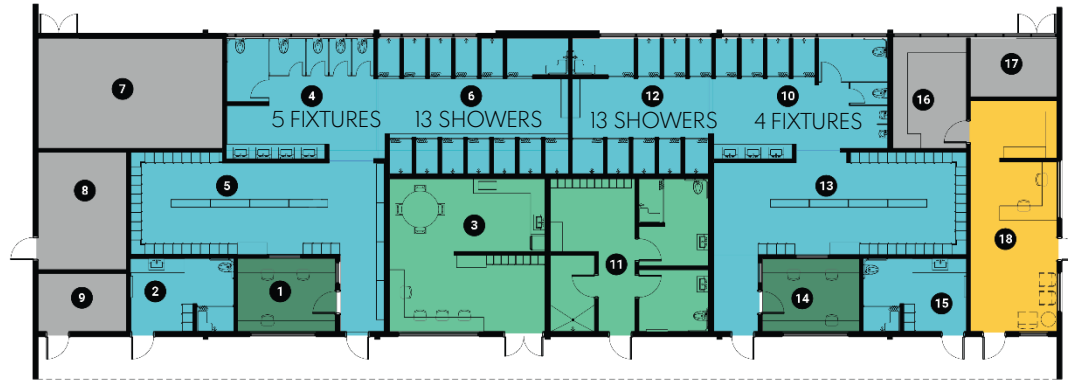

MAIN BUILDING

1 STAFF OFFICE #1	135	10 MEN'S RESTROOM	330
2 FAMILY DRESSING #1	140	11 STAFF DRESSING	450
3 BREAKROOM	435	12 MEN'S SHOWERS	400
4 WOMEN'S RESTROOM	330	13 MEN'S LOCKERS	520
5 WOMEN'S LOCKERS	515	14 STAFF OFFICE #2	135
6 SHOWERS	440	15 FAMILY DRESSING #2	140
7 MECHANICAL	375	16 STORAGE	150
8 ELECTRICAL	190	17 DATA	95
9 CUSTODIAL	95	18 LOBBY / CHECK-IN	365

MECHANICAL

19 POOL STORAGE	505	21 POOL CHEMICAL	90
20 POOL MECHANICAL	625	22 POOL CHEMICAL #2	115

LEGEND

■	RESTROOM/LOCKERS
■	FACULTY OFFICES
■	ADMINISTRATION
■	BUILDING SERVICES
■	POOL EQUIPMENT
■	COMMON SPACE

KEY PLAN

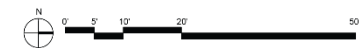
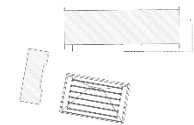

Design Concept Imagery Option 1



Design Concept Imagery Option 1



Design Concept Imagery Option 1



Design Concept Imagery Option 1



Design Concept Imagery Option 1



Design Concept Imagery Option 1



Design Concept Imagery Option 1



Design Concept Imagery Option 1



OPTION 2

New Pools & Buildings

March 25, 2024



Site Plan – Option 2

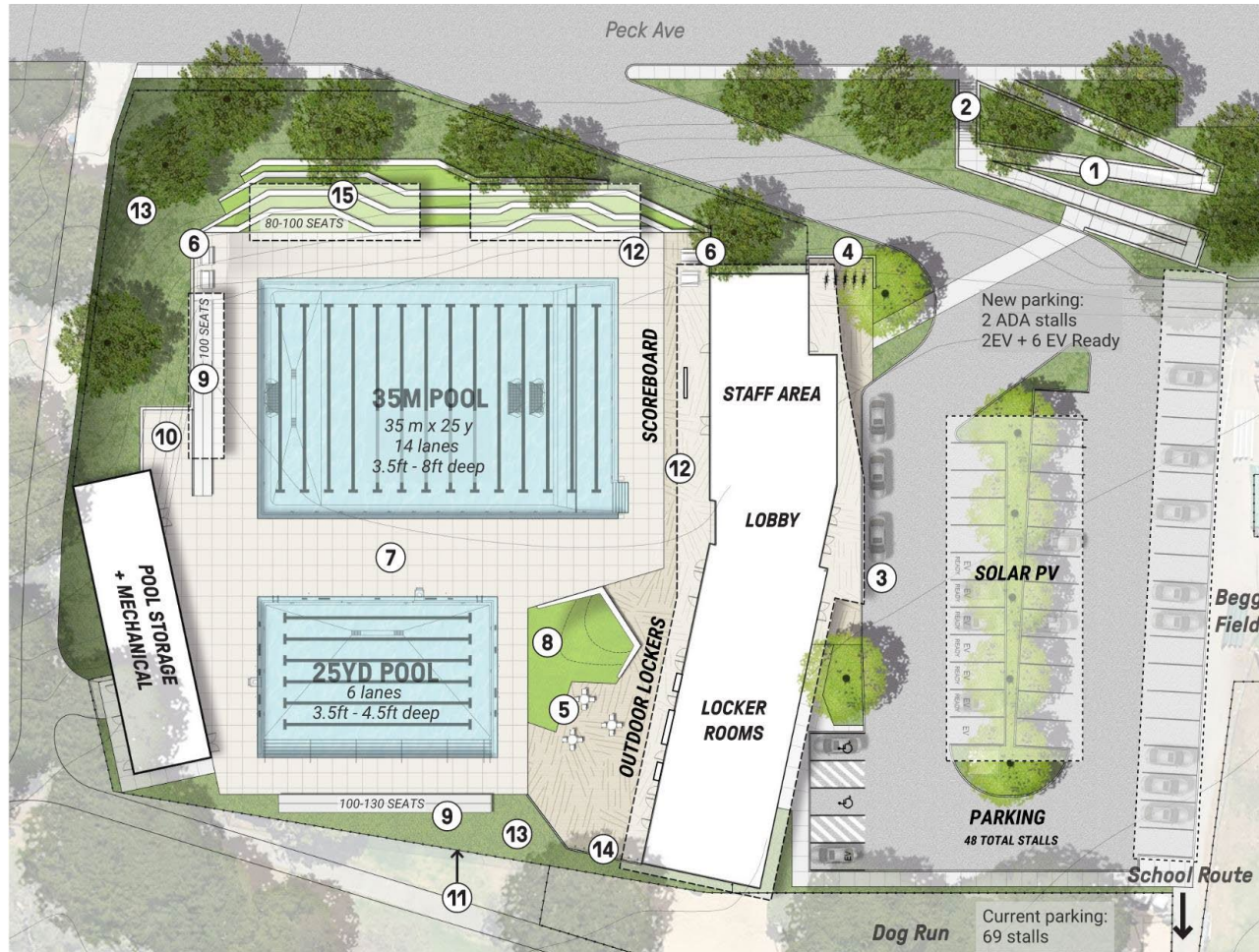

SITE PROGRAM OPTION 2

LEGEND

- ① Accessible Ramp
- ② Entry Stairs
- ③ Entry Drop Off
- ④ Bike Parking
- ⑤ The Huddle
Flexible Lawn + Seating
- ⑥ Seating Area
- ⑦ Pool Deck
- ⑧ Artificial Turf
- ⑨ Bleachers
- ⑩ Outdoor Storage
- ⑪ Perimeter Fence
- ⑫ Shade Canopy
- ⑬ Planting Area
- ⑭ Outdoor Showers (8)
- ⑮ The Bluff
Terraced Lawn + Seating

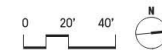

swa

Begg Pool Study



CITY OF
MANHATTAN BEACH

FINDINGS & CONCEPTUAL DESIGNS
MARCH 25, 2024

Floor Plan – Option 2

OPTION 2



MAIN BUILDING

1 LOBBY / CHECK-IN	500	14 WOMEN'S LOCKERS	655
2 TRIAGE	100	15 WOMEN'S SHOWERS	320
3 BREAKROOM	280	16 OFFICE #2	105
4 OBSERVATION	380	17 OFFICE #3	105
5 STAFF DRESSING	445	18 FAMILY DRESSING	100
6 STORAGE	70	19 FAMILY DRESSING #2	100
7 OFFICE	325	20 STORAGE #2	140
8 LIFEGUARD TRAINING ROOM	800	21 STORAGE #3	140
9 MECHANICAL	280	22 MEN'S SHOWERS	320
10 ELECTRICAL	105	23 MEN'S LOCKERS	650
11 CUSTODIAL	100	24 MEN'S RESTROOM	300
12 DATA	135	25 DECK SHOWERS	
13 WOMEN'S RESTROOM	295		

POOL SUPPORT BUILDING

25 POOL STORAGE	500	28 POOL CHEMICAL #2	100
26 POOL MECHANICAL	1545	29 POOL CHEMICAL #3	100
27 POOL CHEMICAL	100		

LEGEND

■	RESTROOM/LOCKERS
■	FACULTY OFFICES
■	ADMINISTRATION
■	BUILDING SERVICES
■	POOL EQUIPMENT
■	COMMON SPACE

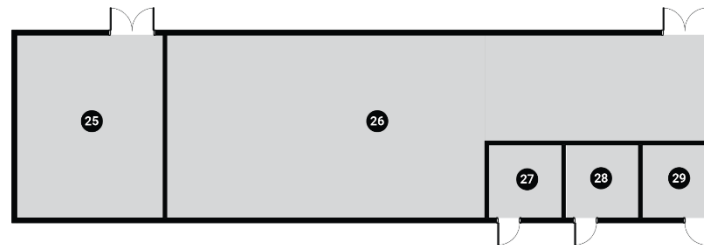

KEY PLAN

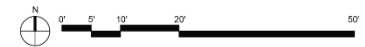
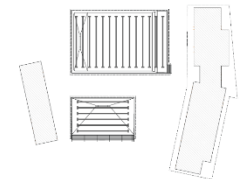

Design Concept Imagery Option 2



Design Concept Imagery Option 2



Design Concept Imagery Option 2



Design Concept Imagery Option 2



Design Concept Imagery Option 2



Design Concept Imagery Option 2



Design Concept Imagery Option 2



Design Concept Imagery Option 2



Design Concept Imagery Option 2



Design Concept Imagery Option 2



Next Steps

- Review of Cost Estimates
- Final Report
- Future Meetings
 - Presentation to City Council: April 16, 2024
 - Presentation to School Board: April 17, 2024

